

Triple offset butterfly valve
Design acc. : EN 12516
Face to face : EN 558-1,G20
Flange acc.to: EN 1092-1
Pressure test : EN 12266-1 .
Body : WCB/CF8M
Temperature range: -29°C-538°C
Operation: Hand lever, gear box,
pneumatic actuator,
electric actuator

**FIG : XXX.923**

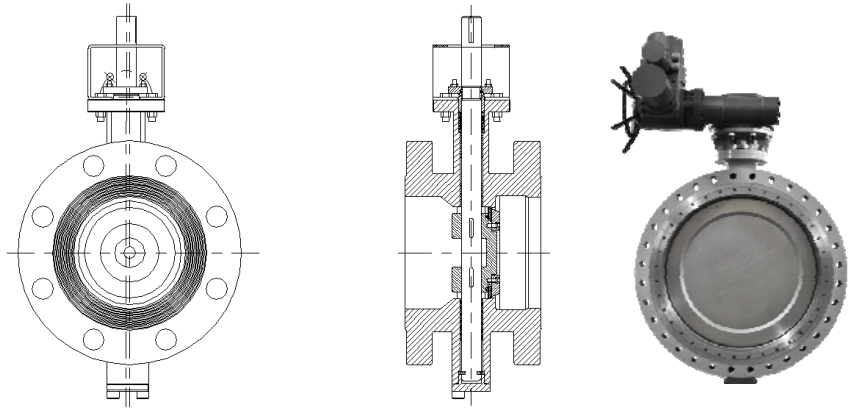
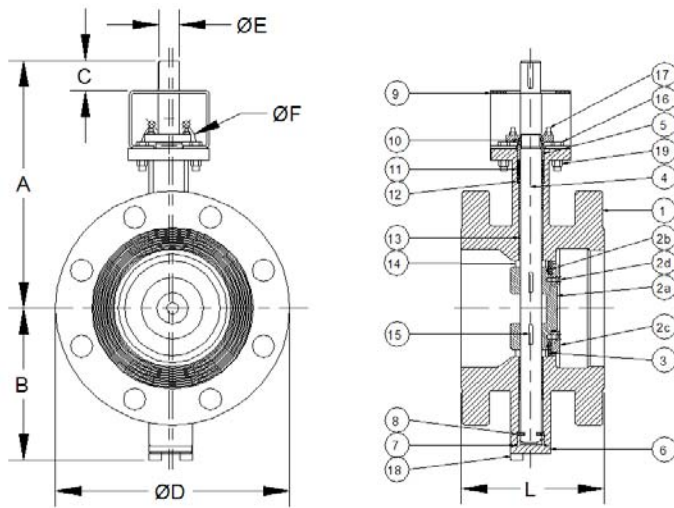

FIG.	Pressure	Material	Range
132.923	PN10	WCB	DN80-DN500
152.923	PN10	CF8M	DN80-DN500
133.923	PN16	WCB	DN80-DN500
153.923	PN16	CF8M	DN80-DN500
134.923	PN25	WCB	DN80-DN500
154.923	PN25	CF8M	DN80-DN500

Design acc. : EN 12516
Face to face : ISO 5752, ASME B16.10,
API 609 Double flanged short pattern
Flange acc. to: EN 1092
Pressure test : EN 12266-1

NO.	Part	Material	
		FIG. 132.923/133.923/134.923	FIG. 152.923/153.923/154.923
1	Body	WCB	CF8M
2a	Disc	WCB, CF8	CF8M
2b	Disc sealing	UNS31803 (duplex) +graphite	
2c	Disc sealing retainer	SS304	SS316
2d	Disc sealing retainer screw	SS304	SS316
3	Seat welded surface	Stellite 21	
4	Shaft	17-4 PH SS,1.4462	
5	Packing gland	CF8	
6	Bottom cover	Same as body	
7	Cover seal	Graphite	
8	Thrust washer	SS316	
9	Bracket	WCB	CF8M
10	Retaining ring	SS304	
11	Packing	RPTFE, Graphite	
12	Packing ring	SS316	
13	Bearing	SS316+PTFE	
14	Thrust bearing	SS316	
15	Key	SS316	
16	Bolt	B8	
17	Bolt	B8	
18	Bolt	B8	
19	Nut	8	

Dimension list

PN	DN	A	B	C	D			E	L	Top flange To ISO 5211	WT(kg)
					PN10	PN16	PN25				
10/16/25	80	260	125	17.5	200	200	200	14	114	F07	30
	100	290	141	17.5	220	220	235	14	127	F07	40
	125	310	150	17.5	250	250	270	14	140	F07	45
	150	330	165	18.5	285	285	300	17	140	F10	50
	200	385	214	24.5	340	340	360	22	140	F10	85
	250	425	243	24.5	395	405	425	22	152	F10	120
	300	490	286	30	445	460	485	27	165	F12	160
	350	525	312	30	505	520	555	27	178	F12	195
	400	545	350	39	565	580	620	36	190	F14	255
	450	580	383	49	615	640	670	46	216	F16	310
500	640	407	49	670	715	730	46	222	F16	390	

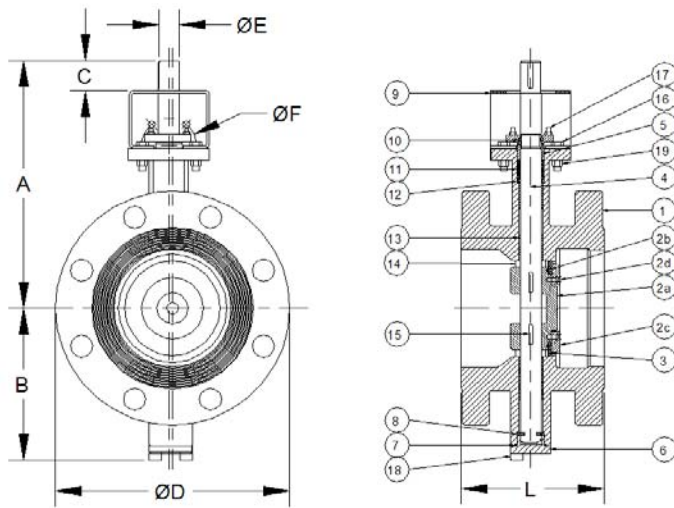

FIG.	Pressure	Material	Range
132.923	PN10	WCB	DN600-DN1200
152.923	PN10	CF8M	DN600-DN1200
133.923	PN16	WCB	DN600-DN1200
153.923	PN16	CF8M	DN600-DN1200
134.923	PN25	WCB	DN600-DN1200
154.923	PN25	CF8M	DN600-DN1200

Design acc. : EN 12516
Face to face : ISO 5752, ASME B16.10,
API 609 Double flanged short pattern
Flange acc. to: EN 1092
Pressure test : EN 12266-1

NO.	Part	Material	
		FIG. 132.923/133.923/134.923	FIG. 152.923/153.923/154.923
1	Body	WCB	CF8M
2a	Disc	WCB, CF8	CF8M
2b	Disc sealing	UNS31803 (duplex) +graphite	
2c	Disc sealing retainer	SS304	SS316
2d	Disc sealing retainer screw	SS304	SS316
3	Seat welded surface	Stellite 21	
4	Shaft	17-4 PH SS,1.4462	
5	Packing gland	CF8	
6	Bottom cover	Same as body	
7	Cover seal	Graphite	
8	Thrust washer	SS316	
9	Bracket	WCB	CF8M
10	Retaining ring	SS304	
11	Packing	RPTFE, Graphite	
12	Packing ring	SS316	
13	Bearing	SS316+PTFE	
14	Thrust bearing	SS316	
15	Key	SS316	
16	Bolt	B8	
17	Bolt	B8	
18	Bolt	B8	
19	Nut	8	

Dimension list

PN	DN	A	B	C	D			E	L	Top flange To ISO 5211	WT(kg)
					PN10	PN16	PN25				
10/16/25	600	690	484	60	780	840	845	55	267	F25	565
	700	720	525	130	895	910	960	80	292	F30	
	750	310	550	130				80	318	F30	
	800	330	600	130	1015	1025	1085	98	318	F30	
	900	385	660	150	1115	1125	1185	120	330	F35	
	1000	425	720	180	1230	1255	1320	130	410	F35	
	1050	490	750	180				150	410	F35	
1200	525	825	200	1455	1485		180	470	F40		